



EQUIPMENT

## GLASS WASHER **PGW 80A**



Every Powerline machine uses a geometrically-perfect fixed-arms washing system (square system for square baskets) which provides a washing quality impossible to find in other machines. A Powerline washing system guarantees complete coverage of the basket interior including the four corners because of its fixed arms with sprinkle-type jets positioned all over the wash tank, which spread water in a spiral movement ensuring total coverage of the wash area. Since the jets don't move, every one of them sends water to its designed area during every single second of the wash cycle. It's a non-stop washing system.

### **STANDARD FEATURES:**

- Door opening height 27 cm
- Double skin door
- Stainless steel wash and rinse system
- Stainless steel tank AISI/304 1mm

# GLASS WASHER PGW 80A

## Technical Data

Power supply	230V / 50Hz
Total power	2.6 KW
Pump power	0.1 HP
Electric absorption	9.15A
Boiler heating element	2500W
Tank resistance	2000W
Boiler capacity	2.1 lit
Tank capacity	14 lit
Water pressure	2-5 bar
Water consumption per cycle	2-2.5 lit
Dishwasher dimensions	420 x 470 x 600 mm
Basket dimensions	350 x 350 mm
Length of cycle	120 SEC
Weight net / gross	27 Kg / 30 Kg
Water connection	3/4"
Draining pipe	Ø29 - Ø34
Stainless steel cabinet	18/8 A ISI 304
Package dimensions	450 x 550 x 770 mm

## ADDITIONAL FEATURES:

- Automatic filling
- Door safety
- Rinse aid valve
- 3/4" pressure hose
- Drain hose
- Thermal protection for broiler and tank
- 2 basket for glasses
- 1 basket for dishes
- DVGW valve

## Detail & Dimensions

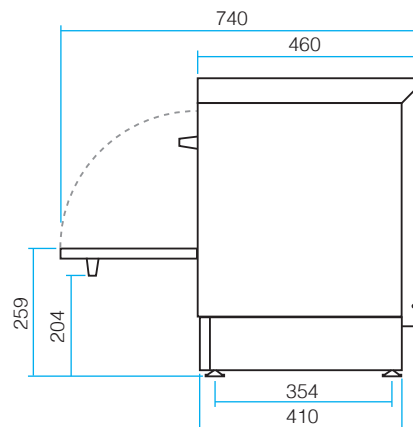
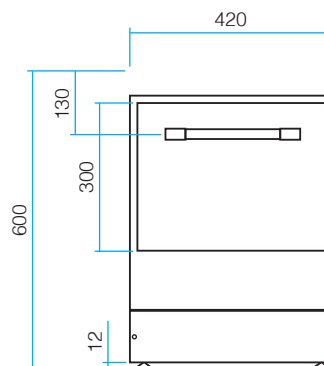

As continued product improvement is a policy of Powerline, specifications are subject to change without notice.



## POWERLINE EQUIPMENT COMPANY

Pulaski Street, Norwalk, CT 06851 USA. Tel: 203-847 2357 Fax: 203-847 6480

[www.powerlineequip.com](http://www.powerlineequip.com)